

DUO-FAST[®]

CNP 65 PNEUMATIC TOOL SAFETY & OPERATIONAL MANUAL

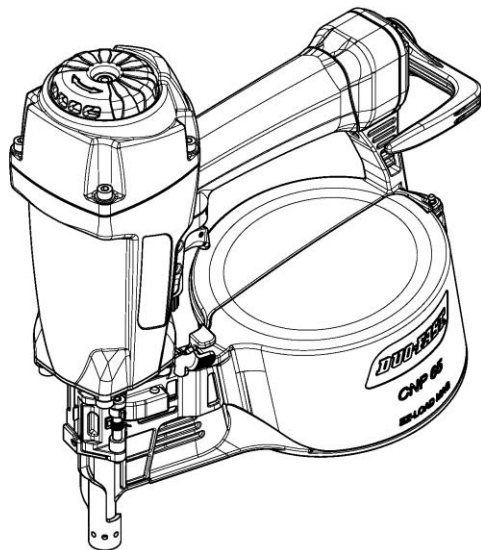

WARNING 



- **READ ALL SAFETY INSTRUCTIONS BEFORE OPERATING THE TOOL!**
- **INJURY MAY RESULT FROM INCORRECT TOOL USE.**
- **ALWAYS WEAR EYE AND HEARING PROTECTION WHEN OPERATING THE TOOL.**
- **NEVER CONNECT PNEUMATIC TOOL TO OXYGEN CYLINDERS.**
- **KEEP THIS MANUAL WITH THE TOOL FOR FUTURE REFERENCE**

SAFETY INSTRUCTIONS

WARNING



READ ALL INSTRUCTIONS. Do not operate the tool until you have read all safety precautions and manual instructions.



AVOID COMBUSTABLE PROPELLANTS. Never use Oxygen (O₂), Carbon Dioxide (CO₂) or combustible gas as a power source for the tool.

Always use clean, dry and filtered compressed air.

Ensure compressed air source is regulated and lubricated.

Do not use gasoline or other flammable liquids to clean the tool.



Vapours trapped in the tool can ignite resulting in tool failure and possible injury.



AVOID OVERPRESSURE. Do not exceed maximum permissible operating pressure 8.3 BAR (120 PSI).



DISCONNECT THE TOOL FROM AIR SUPPLY. Always disconnect air supply before loading and unloading the tool magazine, clearing staple jams or before undertaking any tool maintenance.

ALWAYS ASSUME THE TOOL IS LOADED!

SAFETY INSTRUCTIONS (continued)

WARNING



Exercise extreme care when moving from one location to another to avoid accidental staple discharge.

Only carry the tool by the handle.

Do not carry the tool with your finger on the trigger.

Do not carry the tool by the hose or pull the hose to move the tool.

A sequential trigger is fitted to prevent accidental tool discharge.

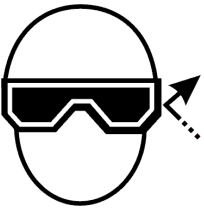

Always wear approved eye protection with side shields that conform to AS/NZS 1337: 19. Free flight fasteners may cause injury.

Always wear hearing protection when operating the tool.



Never point the tool at yourself or at any other person at any time.

Injury may result from accidental tool discharge.

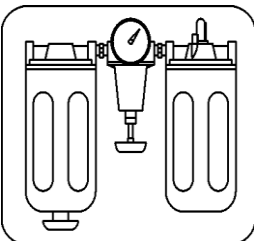

Only use an air compressor that meets AS/NZS 1210 pressure vessel safety standards.

Always use a pressure regulator, filter and oiler.

Always use a supply hose rated for min 13.8 Bar (200 PSI).

Do not use a check valve or any other fitting that allows air to remain in the tool chamber.

TOOL OPERATION

1. Before operation of tool ensure:

- a) Smooth operation of the work contact element.
- b) Smooth operation of the trigger.
- c) All screws are tightened.
- d) A complete visual inspection of the tool for loose, damaged or missing components.

Never operate a damaged tool. Only Paslode Accredited Service Agents are authorised to repair Paslode tools.

- e) Always wear eye and hearing protection when operating tool.
- f) Employers and tool operators are responsible for ensuring the safety of anyone near or operating the tool.

2. Prolong tool life with daily oiling and inspection

- a) Add six drops of Paslode pneumatic air tool oil into the air tool hose inlet before operation.
- b) Wipe off excessive oil from tool air exhaust.

Never use detergent oils to lubricate the tool as these will damage o-rings resulting in tool malfunction.

3. Tool air line hose connection

- a) Install a male quick connect fitting to the tool.
- b) Connect air line hose to an air compressor using a 10mm (3/8") internal diameter air hose that has been connected to the compressor outlet
- c) Connect the stapling tool to the 10mm inlet diameter hose using a female connection on the hose.

TOOL OPERATION (continued)



4. Air Pressure Adjustment

- a) Adjust air line pressure to obtain approx **6.2 BAR (90 PSI)** at the tool.
- b) For best results it is recommended that the air pressure is set between 6.2 - 7.3 Bar (90 - 105psi).

Note: *this will be indicated on the air line pressure gauge located on regulator on the compressor & is not the compressor tank pressure gauge.*

5. Test fire depth of drive

- a) It is recommended that the operator test fire the tool for depth of staple drive on waste timber prior to commencing work.
- b) Depress work contact element and squeeze trigger.
- c) Note depth of drive.

WARNING 

Ensure that the tool magazine is empty and the hose has a rated working pressure exceeding 13.8 Bar (200 psi)

A male air couple must be fitted to the tool to allow for air to discharge from tool once disconnected

TOOL OPERATION (continued)

6. Adjust depth of drive

a) Disconnect stapling tool from air supply.

b) Turn wheel located in front of trigger.

c) Slide the work contact element to the desired position.

Sliding the work contact element away from the body of the tool will decrease the depth of drive.

Sliding the contact element towards the body of the tool will increase the depth of drive.

d) Reconnect the air supply.

e) Repeat depth of drive test until desired depth of drive is achieved.

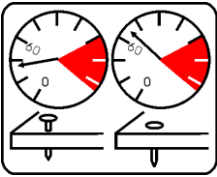

7. Depth of drive for hard timbers

a) If after adjusting the work contact element the depth of drive remains incorrect it is possible to increase depth of drive by increasing the air pressure being delivered to the tool.

Do not exceed 120 PSI (8.3 BAR) at the tool

b) Repeat depth of staple drive test.

WARNING ⚠

Regularly check and replace staples in the tool magazine to avoid damage too stapler tool.

Do not pull trigger of the tool without fasteners in magazine.

TOOL MAINTENANCE

1. Tool Cleaning

Regular cleaning of the tool will prolong tool life.

- a) Disconnect the tool from air supply.
- b) Remove all staples.
- c) Clear the magazine and nose sections with an air duster gun to remove accumulated debris.
- d) Ensure the smooth operation of the trigger.
- e) Ensure smooth operation of the work contact element.
- f) Ensure smooth operation of the staple follower.
- g) Carefully clean away obstructions for smooth operation of all moving components.

2. Compressor

Empty compressor air tanks daily to prevent moisture buildup in the air lines. Moisture in the air lines can dilute lubricants that will dry the tool chamber and result in tool malfunction.

3. Tool Lubrication

- a) Add six drops of Paslode pneumatic air tool oil into the air tool hose inlet before operation. Note: Do not use detergent oils to lubricate the tool as these will damage o-rings resulting in tool malfunction.
- b) Wipe off excessive oil from tool air exhaust.
- c) Do not lubricate magazine or work contact element as these moving components are designed to run dry.

TROUBLESHOOTING

Cease tool operation immediately if any of the following symptoms are evident.

Failure to address symptoms could result in personal injury.

Never operate a damaged tool.

Only Paslode Accredited Service Agents are authorised to repair Paslode tools.

Symptom	Likely Cause	Possible Solution
Weak drive	Tool not lubricated	Lubrication
	Broken spring in cap assembly	Replace spring
	Exhaust port in cap is blocked	Clean exhaust port
Tool jams	Worn or damaged work contact element	Replace work contact element
	Damaged driver blade	Replace driver
	Incorrect size of staples	Use only Paslode fasteners
	Damaged fasteners	Replace fasteners
	Magazine or nose screws are loose	Tighten any loose components
Tool does not fire	Fasteners jammed in magazine or discharge area	Remove any jammed fasteners & inspect and clean magazine
	Piston shaft is damaged	Refer to an accredited Paslode Service Agent
	Air pressure too low	Check increase air pressure <i>Do not exceed 120 PSI (8.3 BAR) at the tool</i>

Air leaking at trigger valve area	Damaged O-rings in trigger valve housing	Replace O-rings and ensure smooth operation of the safety yoke mechanism
-----------------------------------	--	--

TROUBLESHOOTING (continued)

Cease operation of the tool immediately if any of the following symptoms are evident.

Failure to address symptoms could result in personal injury.

Never operate a damaged tool.

Only Paslode Accredited Service Agents are authorised to repair Paslode tool.

Symptom	Likely Cause	Possible Solution
Air leak between housing and nose	Loose housing screws	Tighten housing screws
	Damaged O-rings	Replace O-rings
	Damaged bumper	Replace bumper
Air leak between housing and cap assembly	Loose screws	Tighten screws
	Damaged seal	Replace seal
Tool skips or misses driving fastener	Worn bumper	Replace bumper
	Contaminated work contact element	Clean work contact element
	Contaminants or damaged fasteners preventing operation of the magazine	Clean magazine and / or replace damaged fasteners
	Inadequate air inflow	Inspect hose fitting, hose line, compressor and air pressure
	Worn O-ring on piston	Replace O-rings
	Damaged O-rings on trigger valve	Replace O-rings
	Air leaks	Tighten screws and fittings.

	Air leakage due to worn cap seal	Replace seal
--	-------------------------------------	--------------

Adjusting the E Z Load Magazine



Disconnect the tool from its air supply

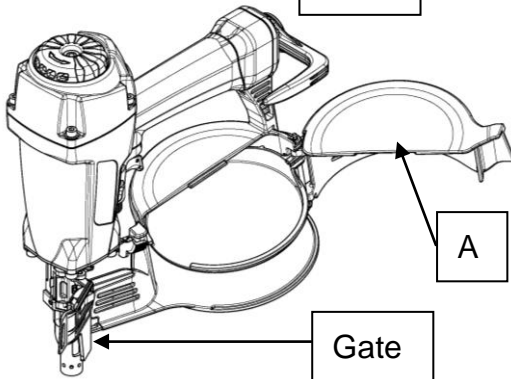

Pull the lever near the Nose allowing the spring loaded Gate open.

Open Magazine Cover (A)

Remove any nails

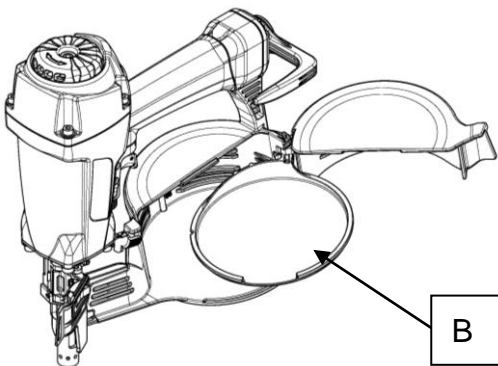

Pull the Magazine Tray (B) away from the tool

Magazine Tray will hinge with Magazine Cover

Adjusting the E Z Load Magazine

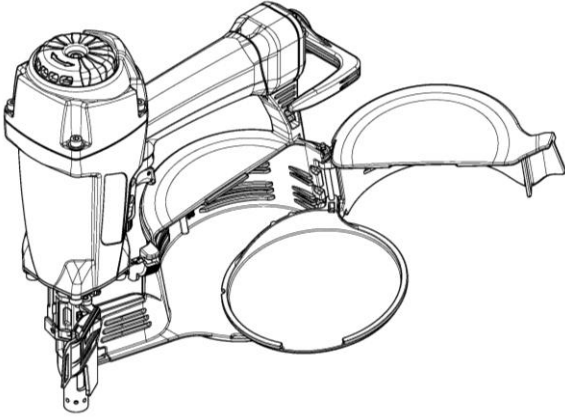

Magazine Tray will slide vertically on the hinge.

Locate the desired height
(Dictated by fastener length)
3 settings to choose from 32mm
50mm & 65mm

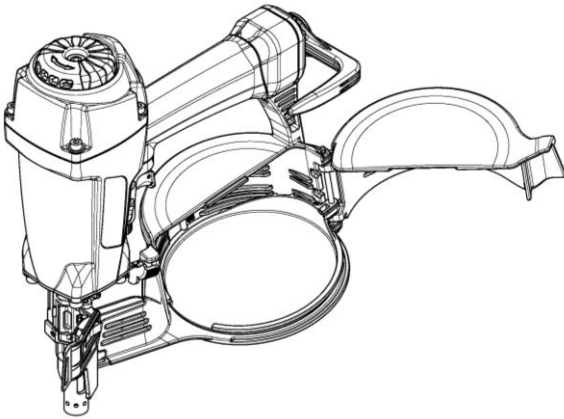

Push Magazine Tray into position until it locks into place

Load nails

Close Magazine Cover

Close Gate to lock the Magazine Cover

Reconnect the air supply



The Duo-Fast CNP 65 is distributed by:



Australia

www.paslode.com.au

New Zealand

www.paslode.co.nz

DUO-FAST[®]

*Paslode® & Duo-Fast are registered trademarks of Paslode (A division of ITW).
© 2010 Paslode®, an Illinois Tool Works Company. All rights reserved.
Paslode Australia ABN: 63 004 235 063*