



SOIL CONDITIONER

The soil conditioner is a versatile, cost-effective attachment no landscaping crew should be without. Its carbide-tipped teeth pulverize the soil, ripping through clumps, leveling the ground and filling in pits and holes. Rocks and other debris are windrowed to the edge of the jobsite for easy cleanup and removal.

Bobcat
ADVANTAGE

PERFORMANCE CHALLENGE

Scan the code to compare soil conditioners side by side and see how the Bobcat soil conditioner is equipped to help you perform better on the job.

Also watch the quality and design comparison.



Prepare the land and lay a good foundation for growth.

- Prepare ground for seed, sod or trees
- Level ground, smooth ruts, clear debris and till soil
- Tear out sod
- Grade topsoil
- Cut swales

Specifications	48 in. Manual	72 in. Manual	72 in. Hydraulic*	72 in. High Flow*	84 in. Hydraulic*	84 in. High Flow*
Overall Length (A)	57.9 in. (1,471 mm)	67.9 in. (1,725 mm)	67.9 in. (1,725 mm)	67.9 in. (1,725 mm)	67.9 in. (1,725 mm)	67.9 in. (1,725 mm)
Overall Width (B)	60.6 in. (1,539 mm)	86.2 in. (2,190 mm)	86.2 in. (2,190 mm)	86.2 in. (2,190 mm)	98.2 in. (2,495 mm)	98.2 in. (2,495 mm)
Height (C)	27.1 in. (688 mm)	26.5 in. (673 mm)	26.5 in. (673 mm)	26.5 in. (673 mm)	26.5 in. (673 mm)	26.5 in. (673 mm)
Working Width (fully angled)	45.7 in. (1,161 mm)	65.0 in. (1,651 mm)	65.0 in. (1,651 mm)	65.0 in. (1,651 mm)	76.0 in. (2,431 mm)	76.0 in. (2,431 mm)
Degree of Angle	25 deg. left or right	25 deg. left or right	25 deg. left or right	25 deg. left or right	25 deg. left or right	25 deg. left or right
Number of Teeth	81	121	121	121	141	141
Operating Weight	636 lb. (288 kg)	1,110 lb. (504 kg)	1,110 lb. (504 kg)	1,110 lb. (504 kg)	1,268 lb. (575 kg)	1,268 lb. (575 kg)
Hydraulic Requirements	10-18 gpm	13-37 gpm	13-37 gpm	25-37 gpm	18-37 gpm	30-37 gpm
Tires	Pneumatic	Pneumatic	Foam-filled	Foam-filled	Foam-filled	Foam-filled
Float or Lock Position	Lock Only	Both	Both	Both	Both	Both
Depth Adjustment	Manual	Manual	Hydraulic	Hydraulic	Hydraulic	Hydraulic
Angle Adjustment	Manual	Manual	Hydraulic	Hydraulic	Hydraulic	Hydraulic

Approved Machines: Skid-Steer Loader, Compact Track Loader, All-Wheel Steer Loader, Mini Track Loader, Toolcat™ Utility Work Machine * Attachment Control Kit required.



Bobcat

Bobcat®, the Bobcat logo, and the colors of Bobcat machines are trademarks of Bobcat Company.

For more information



SOIL CONDITIONER

REPLACEABLE CARBIDE-TIPPED TEETH

Easily rip through hardpan and pulverize clumps for maximum ground penetration. Individual teeth are replaceable for easy attachment maintenance.

DIRECT-DRIVE HYDRAULIC MOTOR

Eliminates the need for sprockets and chains, resulting in a more durable product that requires minimal maintenance.

DRUM POSITIONING

To level and grade a surface, lock the drum for a box blade effect. Or place the drum in the float position to follow the contours of the terrain and prepare the soil without leveling sculpted land.

FOAM-FILLED TIRES

Featured on the 72- and 84-inch hydraulic and high-flow models, foam-filled tires protect your productivity by eliminating flat tires on the jobsite.

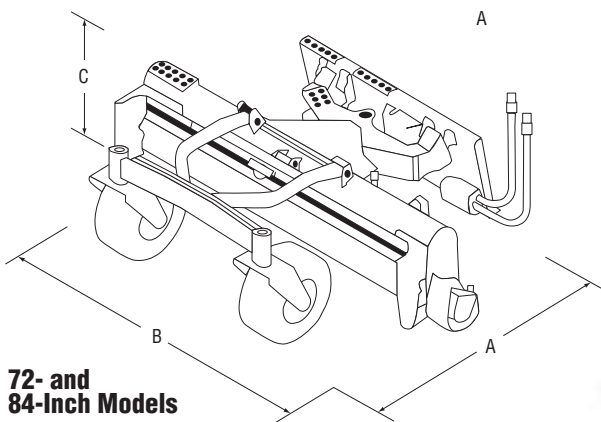
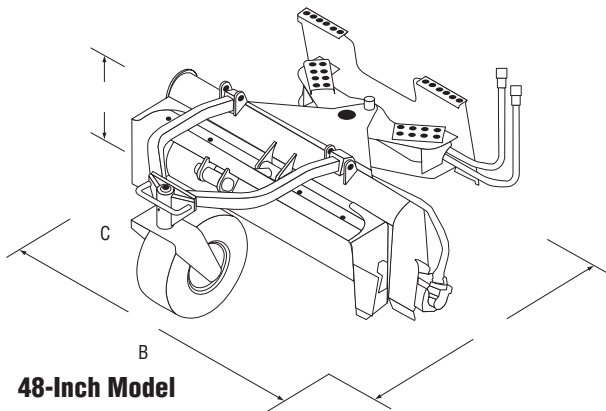

OSCILLATING BOLSTER

An oscillating bolster – standard on 72 inch and larger models – keeps the drum parallel to the ground to minimize the effect of bumps and potholes, resulting in a smoother finish in fewer passes. The oscillating bolster, combined with hydraulic depth and angle controls also make it easy to sculpt the land or cut swales for drainage.

FRONT BOLSTER

Designed with a wide stance, the front bolster provides enough room between the wheels and drum to let material in front of the drum, delivering better grade control. Flip the bolster up to create extra room for storage or when transporting.

INTEGRATED CONTROLS

Hydraulic and high-flow models feature hydraulic adjustment of angle and depth control which are easily controlled on the fly from the integrated controls inside the cab.

INCREASED DRUM TORQUE

High-flow models feature increased drum torque for moving more dirt and grading more efficiently. Increased drum torque is especially beneficial when operating in rich soils.

REMOVABLE END PLATES

When removable end plates are attached, soil in front of the drum is carried along like a box blade and fills in low spots for an even finish. Without, material is pushed to the side and can later be picked up with a bucket.

RUBBER FLAP

Keeps large material from going over the drum and allows finer material through.

